

Aviary Rearing System

POTTERS ARE LEADING SUPPLIERS OF POULTRY EQUIPMENT

A REVOLUTIONARY CONCEPT IN MULTI TIER AVIARY REARING SYSTEMS

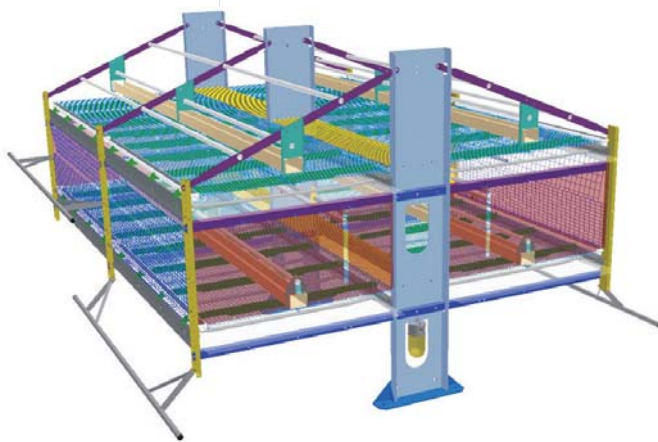

System is closed

- Day old chicks housed on 1st or 2nd level
- System is closed from day old to 4-6 weeks

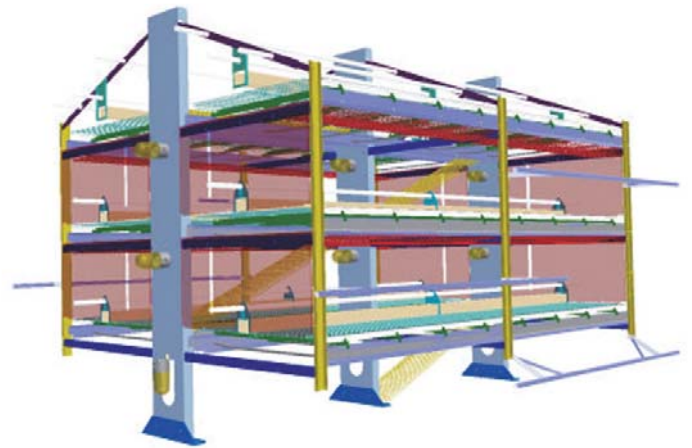

System is open

- 4-6 weeks onwards the system is fully open
- Pullets have access to the whole house
- Pullets can move up and down within the system for full training for all multi tier systems

Aviary multilevel system for healthy pullet rearing

Aviary Rearing System

Why Potters Aviary Rearing System is unique

- It is designed by farmers to be used by farmers
- Healthy and well trained pullets are a priority
- Easy bird management
- Open system making it better to see and manage the hens
- A simple support system with very little of the structure fixed to the floor – meaning easy cleaning
- Lighting available on all levels
- All necessary perching, feeding and drinking provided within the system
- Choice of belt numbers and levels
- Flexible system allows effective installation according to building dimensions

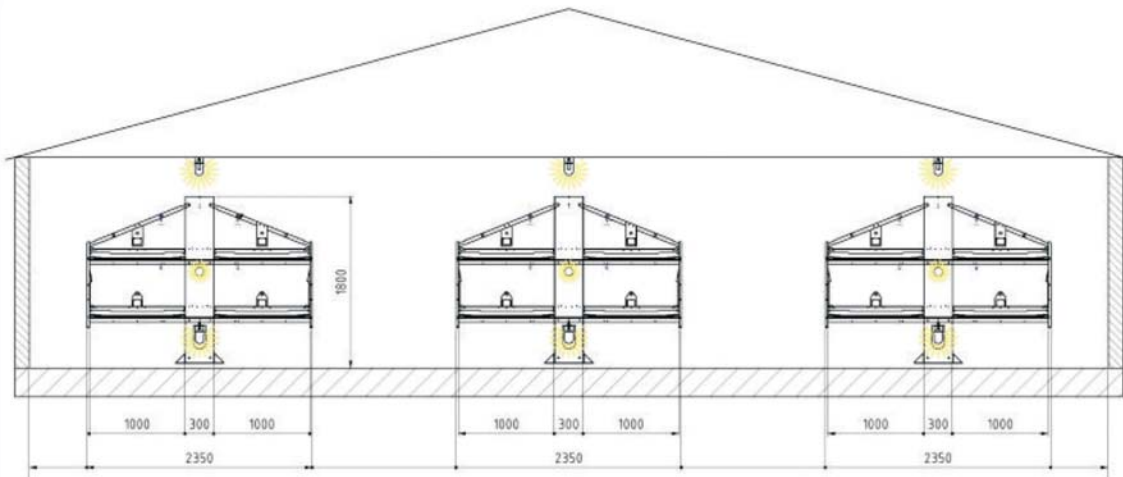

Two tier aviary system

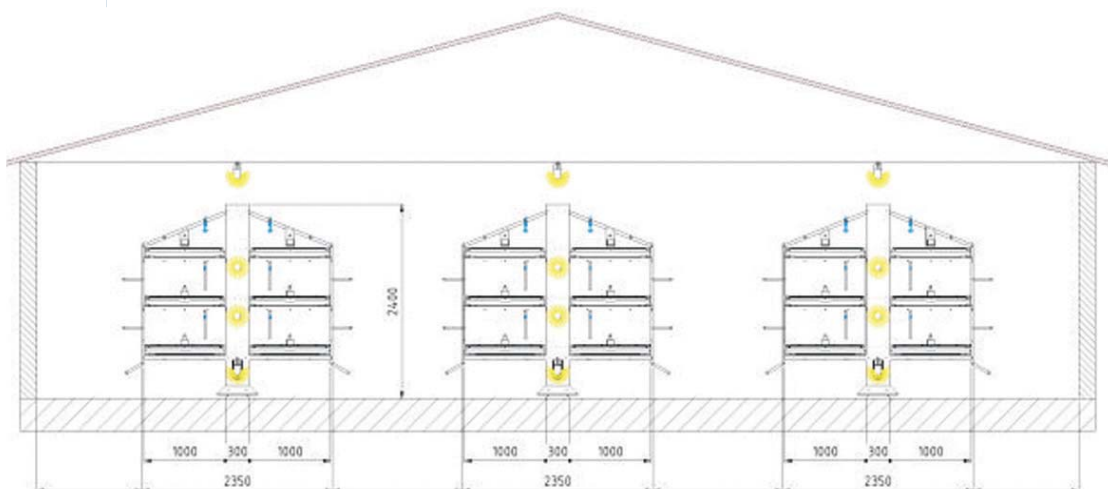

Three tier aviary system

Willey Fields Farm, Willey, Rugby, Warwickshire CV23 0SQ United Kingdom

Tel: +44 (0) 1455 553234 Fax: +44 (0) 1455 550593

info@potterspoultry.co.uk www.avinest.com