

GrowerSELECT™ HS583-SWRLR Latch out / Auxiliary Switch Kit

Installation and Operating Instructions

The HS583-SWRLR Auxiliary Switch Kit for HS583 Series curtain / Vent machines provides a Normally Open and Normally Closed switch contact activated by the load block

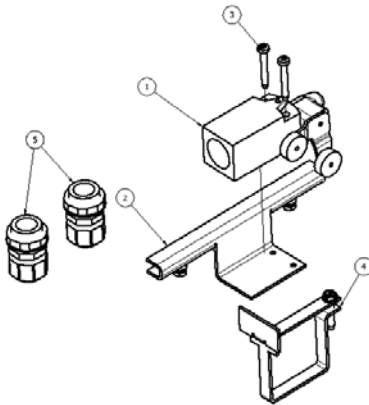

Part #	Description
EL1194	Switch, double fork roller
HS583-SWRLR-1	Bracket assembly
616555	8-32 x 1 ¼ Phillips screw
HS583-SWRLR-4	Bracket, Trigger Assembly
61646	½" Liquid tight connector

Installation Instructions:

Install trigger bracket to load block per below steps.

1. Bottom section of trigger bracket HS583-SWRLR-4. Place underneath load block as shown. Rotate to side to provide clearance and slide underneath load block. Position bottom bracket toward the center of the load block just past the inboard cable set screw as shown below.

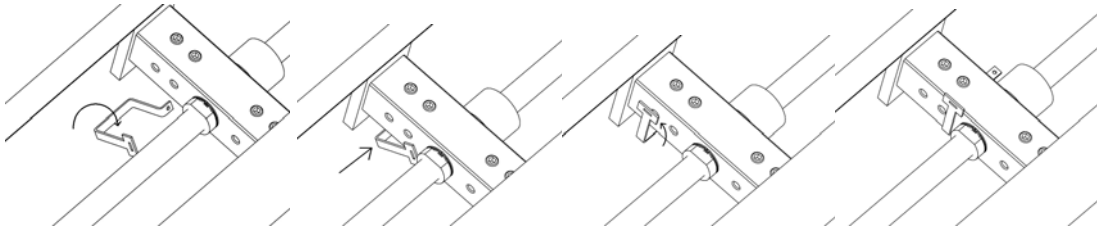

2. Slide top section of trigger bracket HS583-SWRLR-4 through slot on bottom section as shown. Slide all the way through until screw holes on each bracket align. Insert provided 10-32 x 1" hex head screw and tighten.

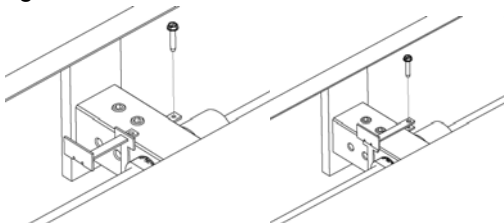

- Slide switch mounting bracket assembly HS583-SWRLR-1 onto **left** side flange of curtain machine cabinet. This bracket can be mounted anywhere along with length of the cabinet inside the travel range of the load block. Position should be based on the location that actuation of the auxiliary switch is required. Once in place, tighten the (2) screws in the mounting bracket with a 5/16" wrench or socket. Tighten (2) lock nuts with a 3/8" wrench or deep well socket.

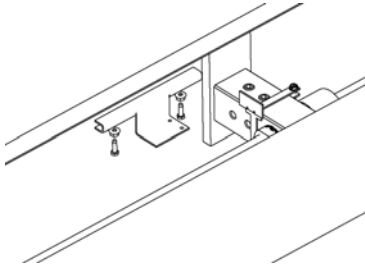

- Mount limit switch to bracket using provided (2) 8-32 x 1 1/4" Phillips head self tapping screws. Place roller fork arm on the limit switch as shown. **Make sure load block is positioned past the HS583-SWRLR switch toward the top of the machine or cable exit end. This will ensure the limit switch is installed correctly.**

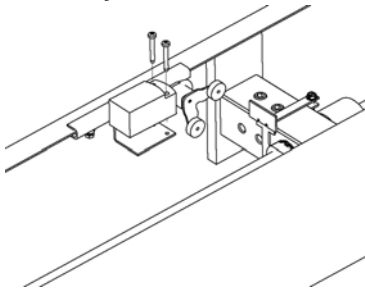

- Remove screw retaining top cover of limit switch.

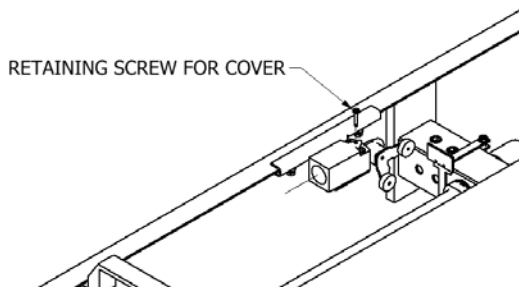

- Connect wiring to internal switch. Both Normally Open and Normally Closed circuits are provided.
- Use liquid tight connector to secure wire at entrance of switch. (Connected to Normally Closed Contacts shown as example only)

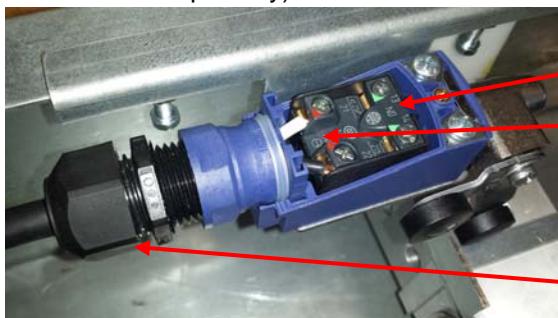

Normally Open

Normally Closed

Liquid Tight Connector

8. Route cable outside of load block area before exiting the machine. Openings are available to route cables away to provide clearance for the Load block travel.



9. Exit points can be through side of the machine (as circled below) or route cable to bottom of machine and exit through bottom plate.



10. (1) Liquid tight connector is provided for exiting the machine housing. If used, drill 7/8" ID hole through cabinet wall and install liquid tight connector.
11. Protect cable/wires from metal edges by adding protective covering over wire to prevent wire damage.

Electrical Rating:

Contact voltage AC MAX: 240 VAC
Contact current AC MAX: 10 A

Contact form: Normally Open and Normally closed single action

This equipment must be installed in accordance with all State and Local Codes and applicable Regulations which should be followed in all cases. Authorities having jurisdiction should be consulted before installations are made.



Hog Slat, Inc.
PO Box 300
Newton Grove, NC 28366
Phone: (910) 594-0219
Fax: (910) 594-1392
www.hogslat.com
Copyright © 2016 by Hog Slat, Inc

Part Number: HSMANUAL-083
REV A1

Market: Hog & Poultry